

# TH-BR22 Programmable Thermostat

## HL3 wiring instructions



### Specifications

**Range:** 45°F to 90°F (7°C to 32°C)

**Differential:** Adjustable temperature differential (0.5°, 1°, or 2°)

**Operation:** Single or two stage operation

**Electrical Rating:** 24 VAC (18–30 VAC)

1 amp maximum load per terminal

4 amp total maximum load (all terminals)

**Dimensions:** 4.25"(108 mm) x 5.12"(130 mm) x 1"(25 mm)

**Additional Features:** Bright blue backlight, hardwire or battery powered, installer lock mode, and SpeedSet programming mode

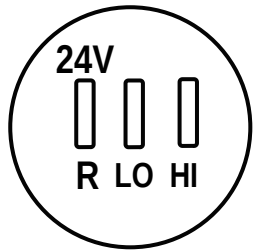
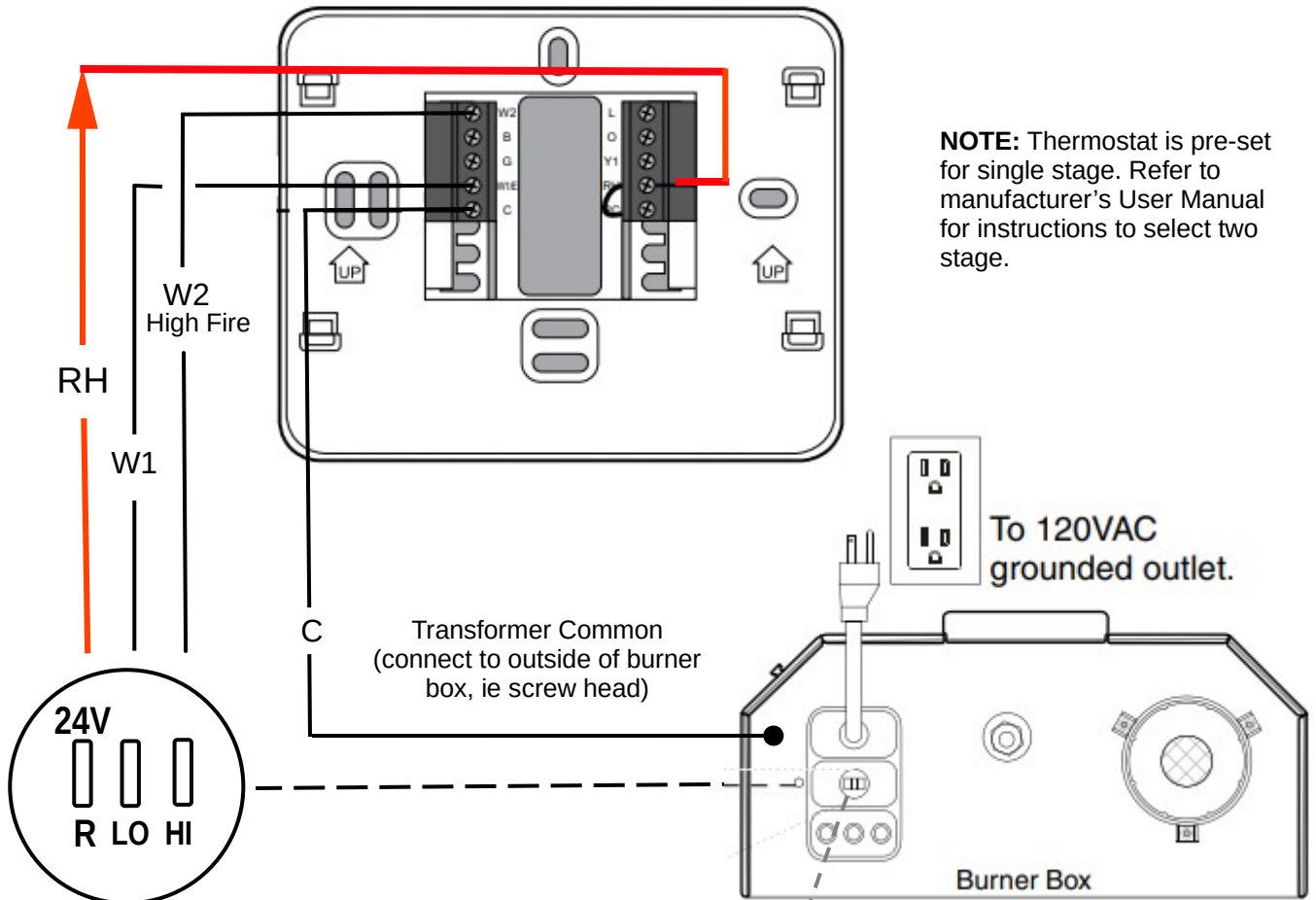

¼" terminals

**R:** 24 VAC Power out

**LO:** Low fire

**HI:** High fire

### HL3 Two Stage Heater

**Note:** If optional yellow control cord "OD Kit" is installed then the following wire colors apply:

**24VAC out** = Green

Low = White

High = Black

