

# LYTUtility Series B

**NSF Rated LED  
Food Service Lighting**



Efficiently illuminate any Food Service, Processing, or Distribution Areas with our high performance LED Fixtures with quality Meanwell Drivers.

Reduce energy costs and greatly improve your light quality with our NSF Rated LYTU-B Series Fixture. This Compact fixture is available 100, 120, or 150 watts in 4000K or 5000K options, giving the flexibility needed for all your food service lighting.

## PRODUCT FEATURES

- NFS Rated for easy cleaning
- IP65 rated for wet environments
- High quality Meanwell driver
- Rugged aluminum housing
- Shock and vibration resistant

## BENEFITS OF LED LINEAR LIGHTING

- Modular Design
- Reduced Energy Consumption
- Maintenance Free
- Long Life Expectancy
- Durability
- Superior Light Quality
- High Efficiency

# LYTUtility Series B

## NSF Rated LED Food Service Lighting



### Product Specifications

**Electrical:**  
**Input Voltage:** 110 to 277 VAC  
**Input Frequency:** 60 Hertz  
 Compatible with Leviton or equal 0-10V Dimming Systems  
 Includes 5' 300V SJO Cord with 125V Standard three prong plug.

**Photometric:**  
**Lumen Range:** 13,000, 15,600, and 19,500  
**Wattage Range:** 100, 120, 150 Watts  
**Color Temperature (CCT):** 4000K or 5000K  
**CRI:** 90

**Rated Life:**  
 50,000 hours  
**Operating Temperature:** -30 ° C to 45 ° C Ambient Temp

**Mounting:**  
 Suspended

**Housing:**  
 White Powder Coat Standard with Stainless Steel Hardware and Mounting Hook. IP 65 Rated for Wet Locations.

**Certifications:**  
 NSF, ELT, DLC Premium

**Limited Warranty:**  
 5 year

### Available LYTUtility NSF Rated LED Lighting Models

MODEL #	APPLICATION TYPE	TYP. MOUNTING HEIGHT	LUMENS	WATTS @ 277VAC	LUMENS/ WATT	CRI	BEAM ANGLE	WEIGHT	LENGTH (X)	HEIGHT (Y)
LYTU-B130	NSF Rated	8' to 16'	13,000	100	130	90	120°	12 lbs.	13.4"	4.75"
LYTU-B160	NSF Rated	10' to 24'	15,600	120	130	90	120°	14 lbs.	15.4"	5.25"
LYTU-B200	NSF Rated	14' to 40'	19,500	150	130	90	120°	14 lbs.	15.4"	5.25"

### Dimensions

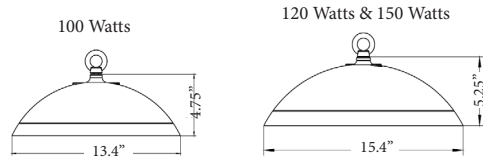

This Re-Verber-LYT LED lighting fixture must be installed correctly. The contractor, owner, installer, purchaser, and user is responsible for installing, maintaining, and operating the light fixture in compliance with all state and local laws, ordinances, regulations, and the American National Standards Institute (ANSI) Safety Code.

The validity of the product warranty is subject to the correct storage, installation, operation, and maintenance of this product. Failing to comply with proper storage, installation, operation, and maintenance routines will make the warranty invalid. Specifications subject to change without notice.



**DETROIT RADIANT**  
 PRODUCTS COMPANY

21400 Hoover Road, Warren, Michigan 48089 USA  
 +1.586.756.0950 | sales@drp-co.com

[www.REVERBERLYT.com](http://www.REVERBERLYT.com)



Form No. LBBUT\_1M-1118 (xxx)

